

1. Westlicher Pavillon des Louvre. Erbaut von Pierre Lescot (1510—0578).

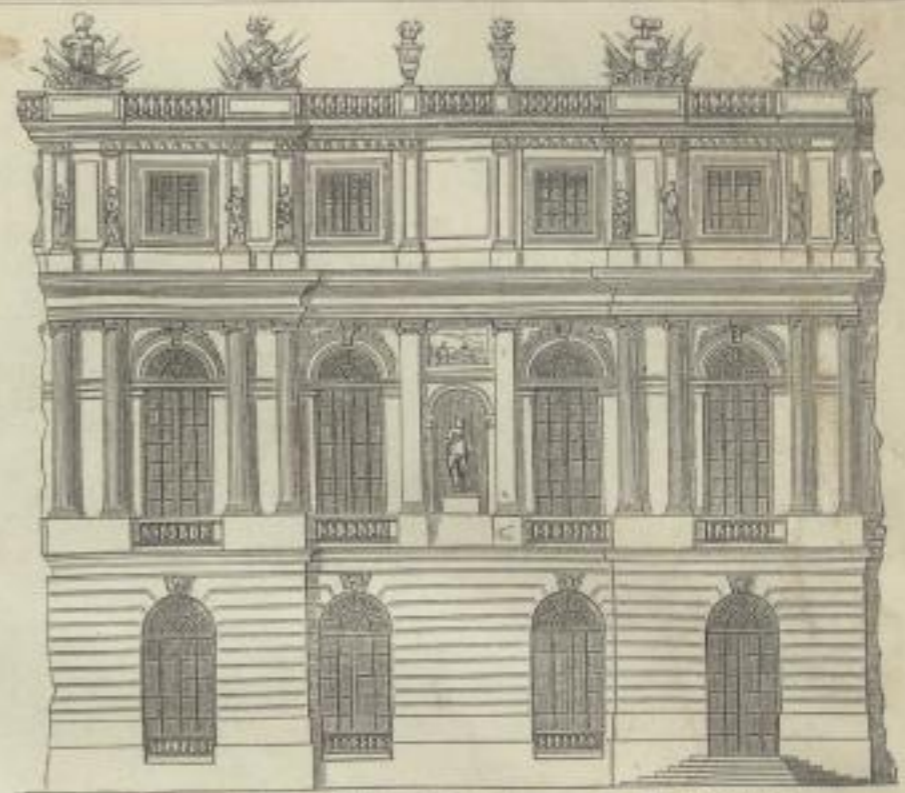

3. Versailles. Teil der Fassade von J. H. Mansart.

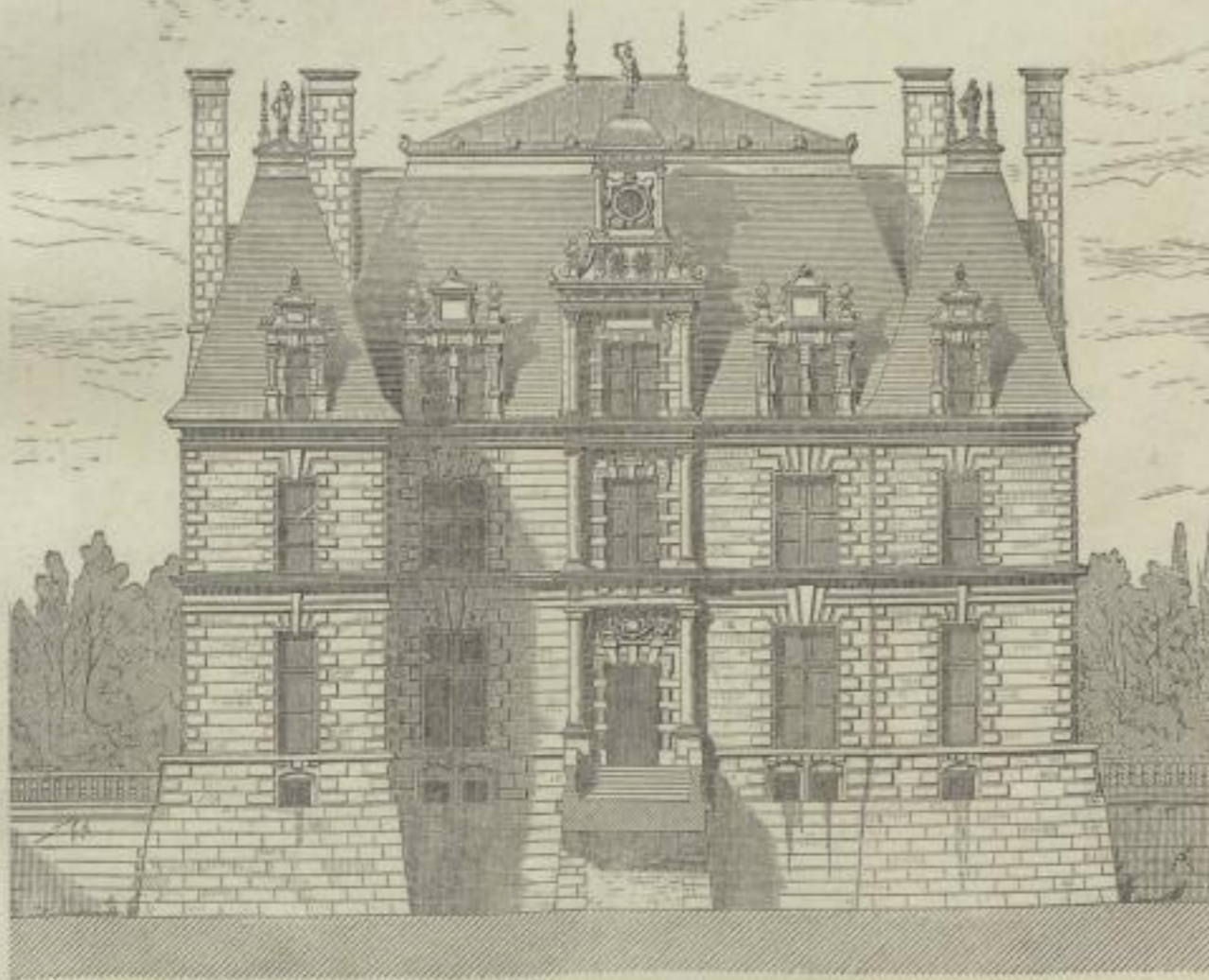

2. Schloss Angerville in der Normandie. Um 1600.

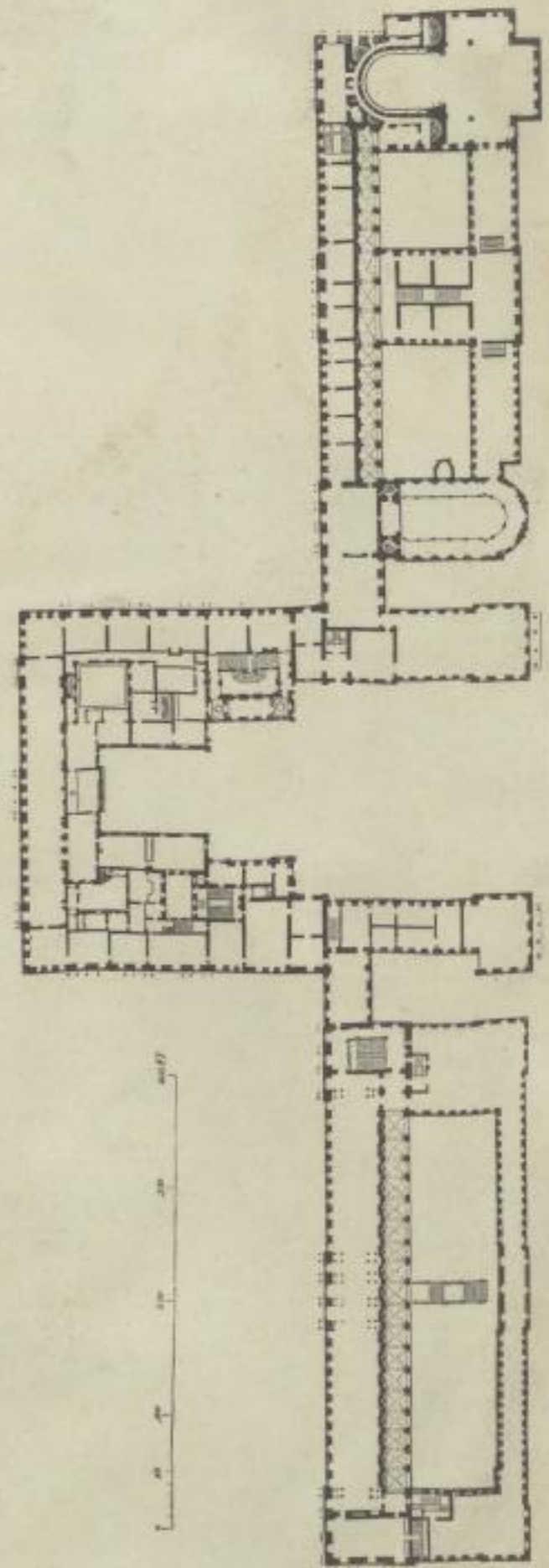

4. Grundriss des Schlosses zu Versailles. Baumeister: Jules-Hardouin Mansart, (1645—1708.)