

Neue Bessemer und Siemens-Martin-Hütte in Besitzau, Längenschnitt. (Fig. 7-8).

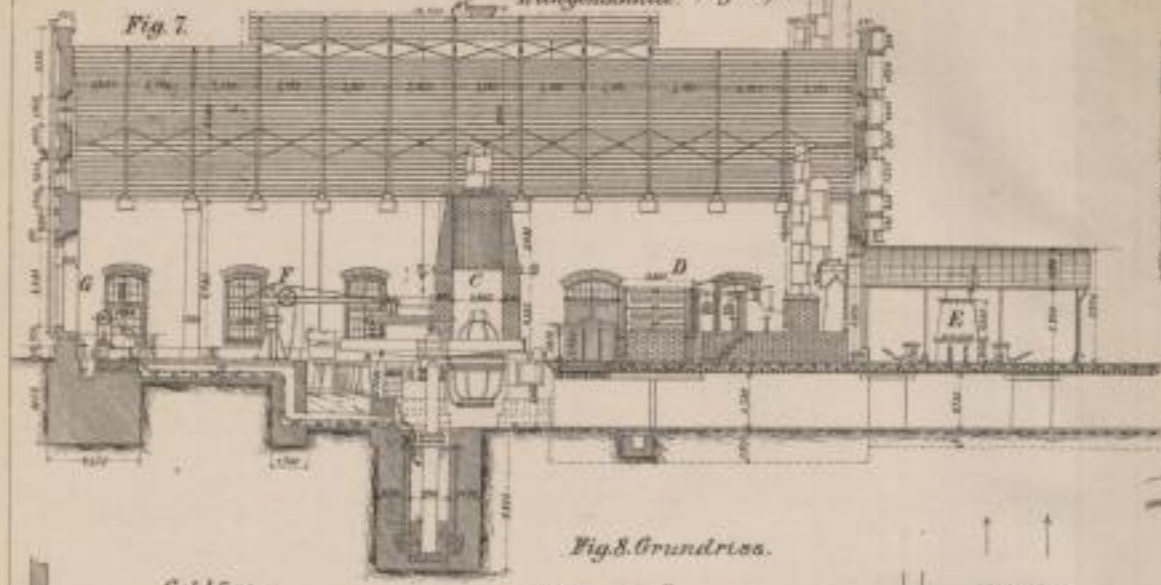

Schweißofen-Feuerung in Donawitz.

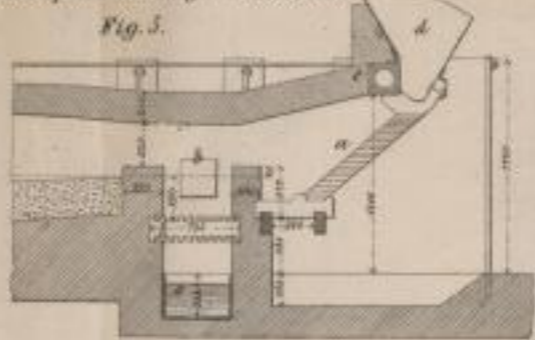

Stahlwerk Eibismuld.

Fig. 9.

Ventil Reversir-Vorrichtung in Donawitz. Fig. 6.

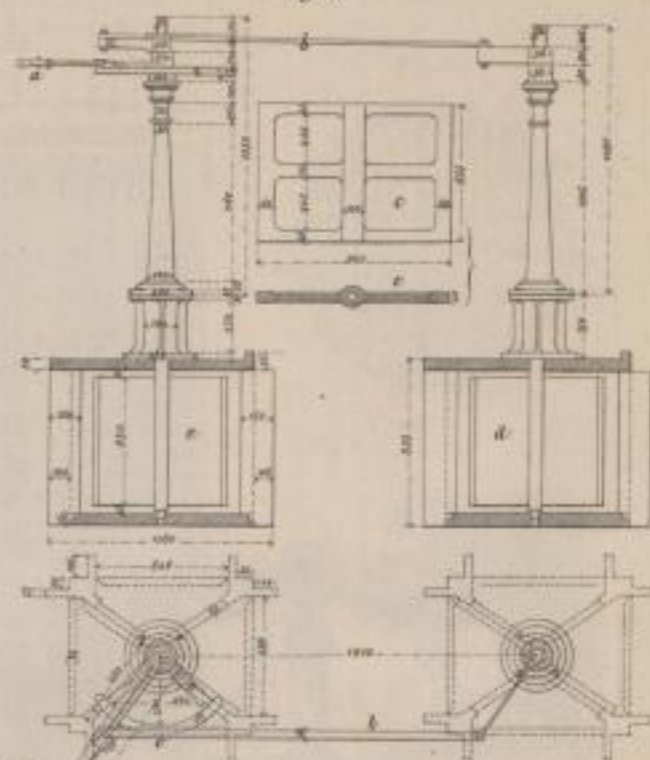

Giesserei-Vorrichtung in Anna. Fig. 1.

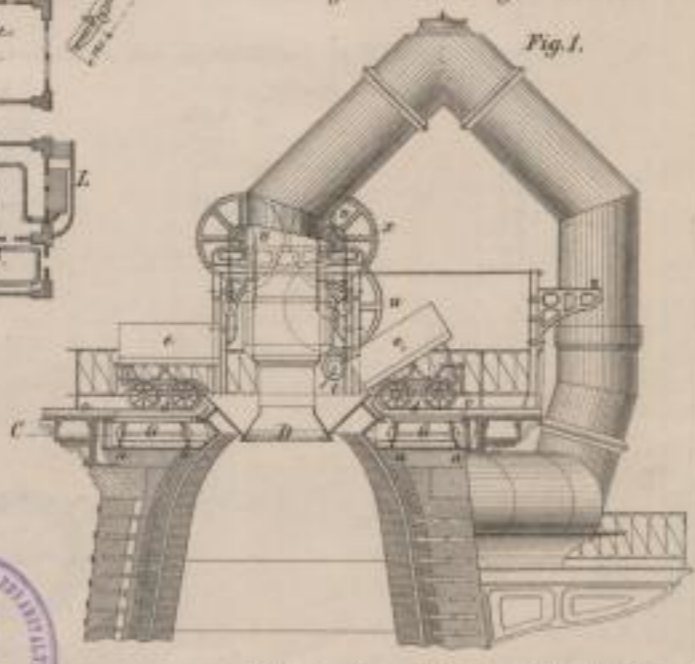

Fig. 8. Grundriss.

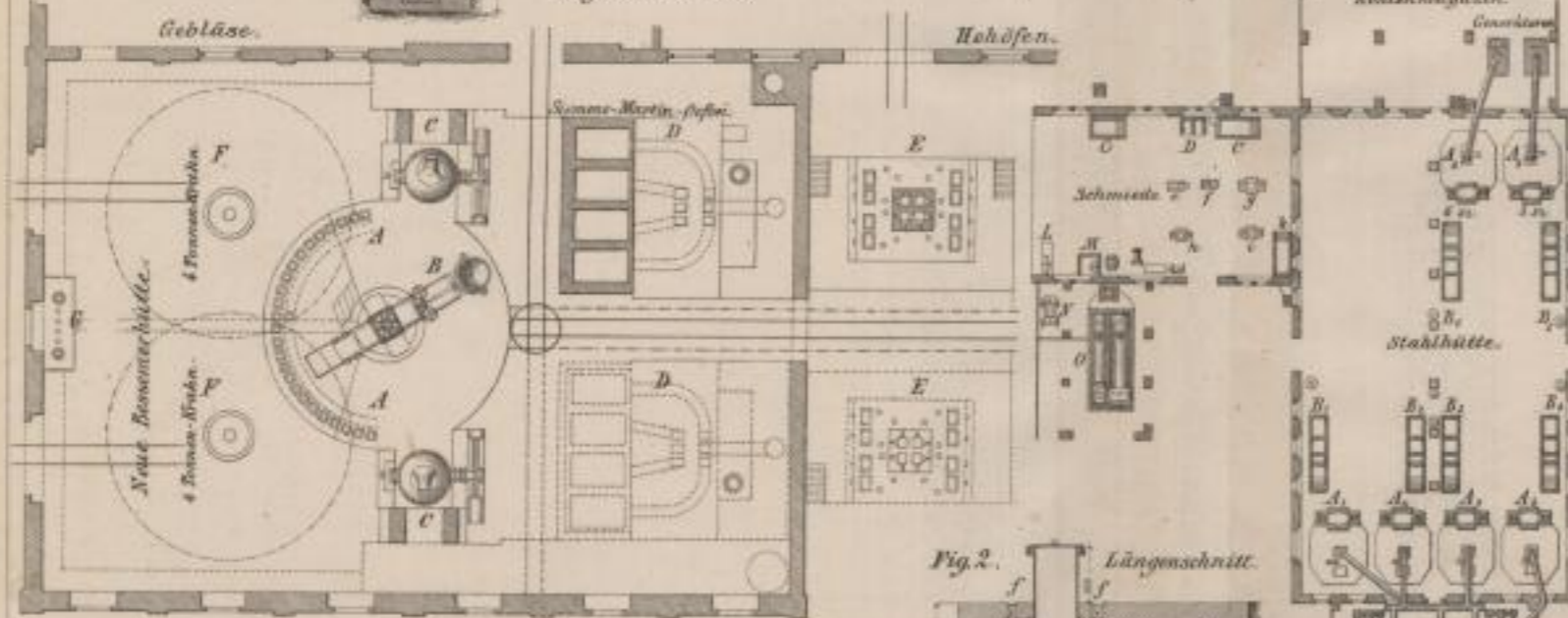
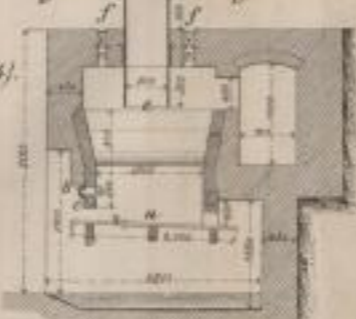

Fig. 2. Längenschnitt.



Generator in Donawitz (Fig. 2-4).

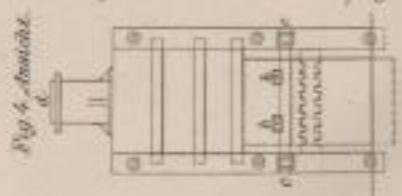

Fig. 4. Ansicht.

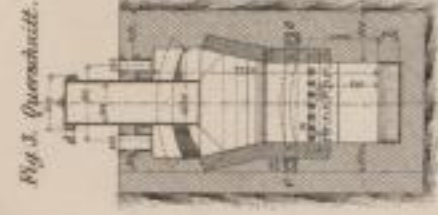

Fig. 3. Querschnitt.

Verlag von Arthur Felde in Leipzig.

lith. Ant. v. Schwanitz & Bornemann in Meissen.

