

Eisenbahn-Wagenräder mit hölzernen Speichen und Felgen.

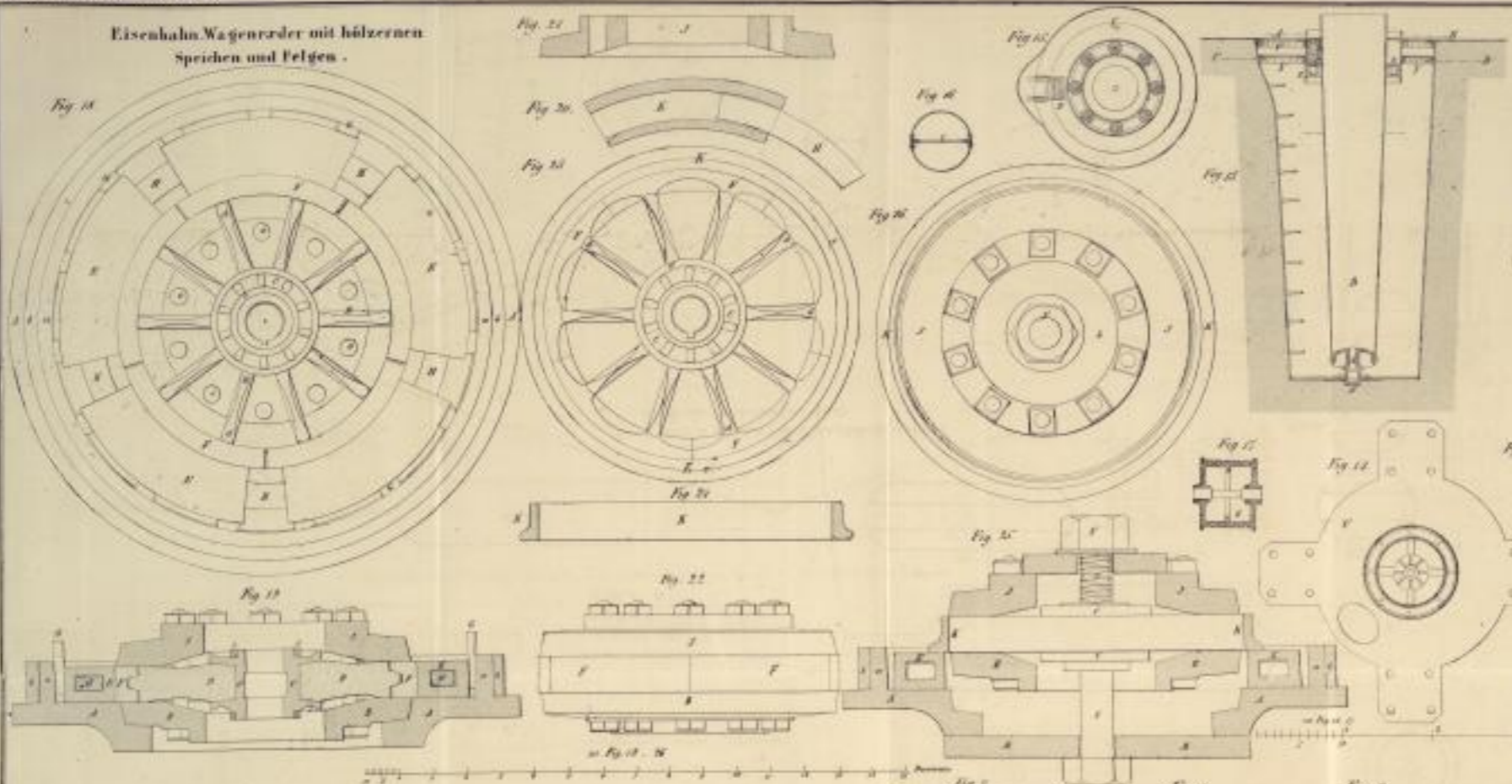

Apparate zum Bleichen der wollenen und halbwollenen Zeuge.

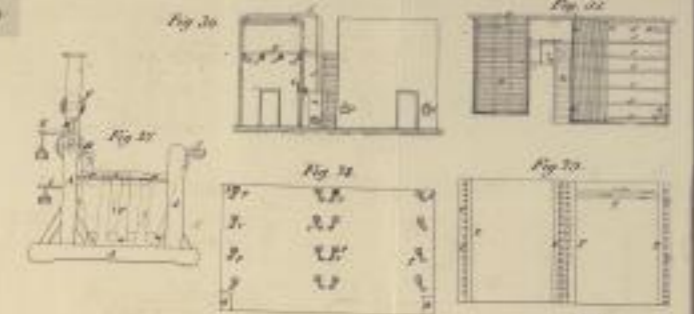

White's Feuerspritze.

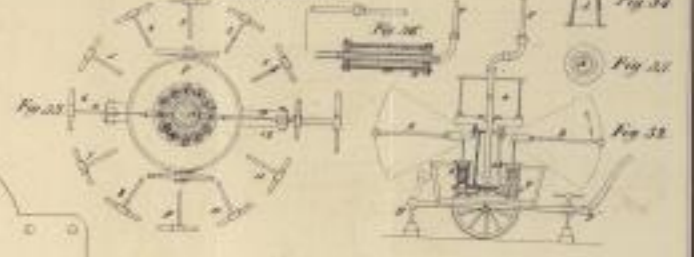

Nickel's Planorbte.

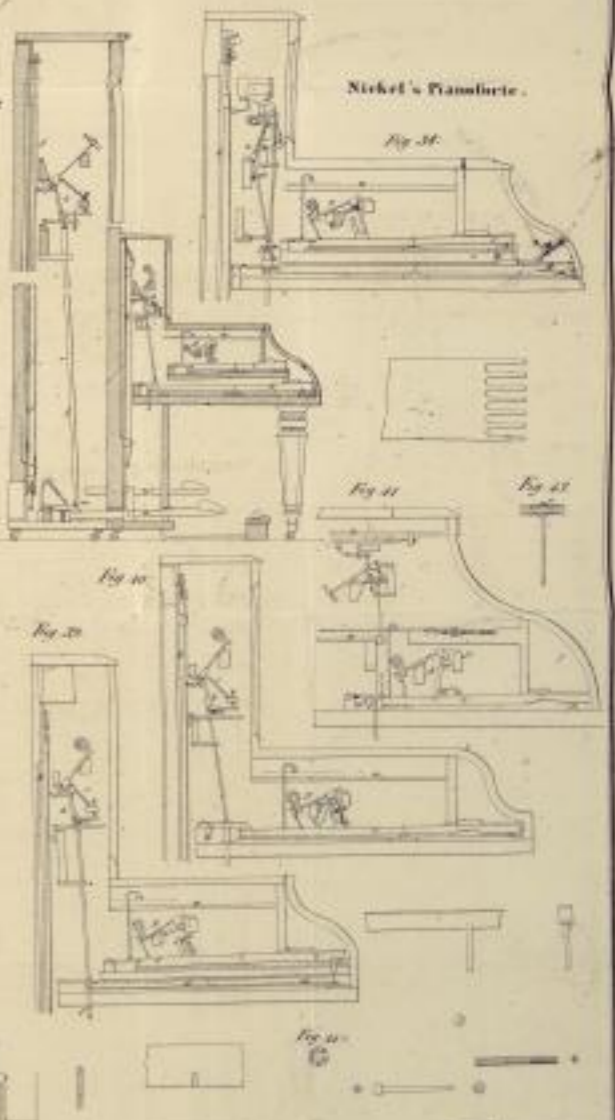

Lemaître's Kran von Eisenblech, welcher auch als Schnellzug dient.

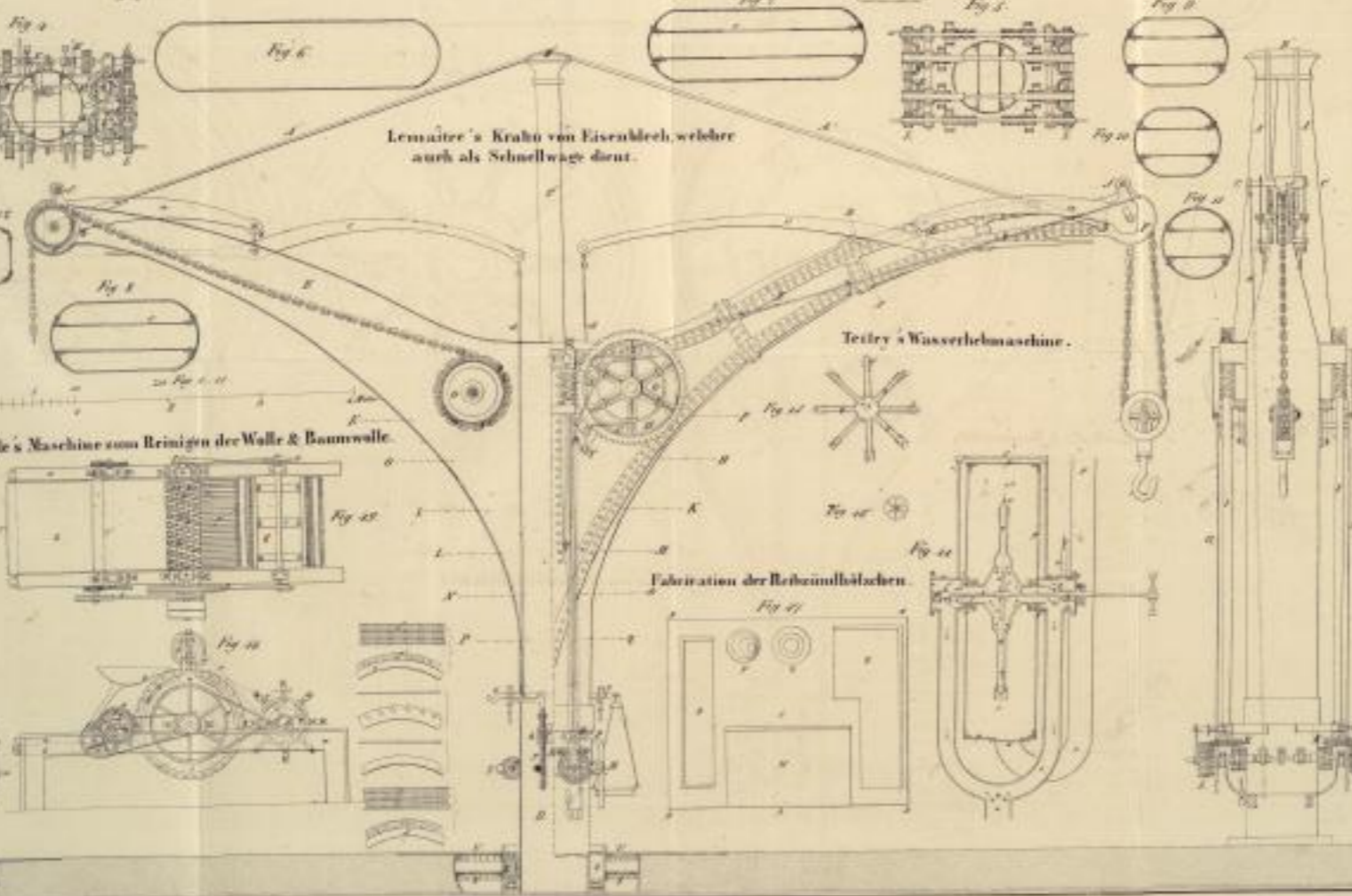

Hale's Maschine zum Reinigen der Wolle & Baumwolle.

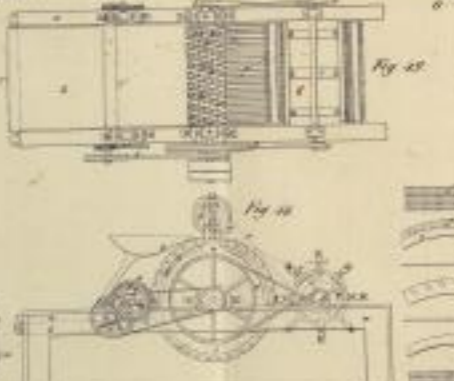

Tetry's Wasserpumpmaschine.

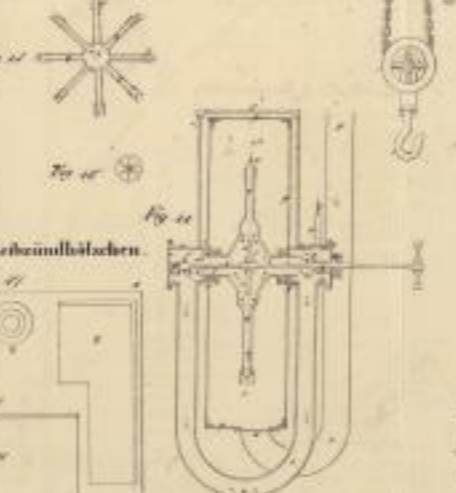

Fabrikation der Reibzylinderhölzchen.

